



⚠ A brief instruction for when you need to act quickly.

MALFUNCTION OR LEAKAGE?
Act immediately to minimize water damage
as much as possible!

What to do?

Go to the **DRIES** box in the storage room in your home:

- 1** Slide the middle panel B from the bottom up and remove the panel.
- 2** Close all valves: 3 red handles and 3 blue handles.
- 3** Contact us immediately!

☎ 085 0655360 (CHOOSE 1)

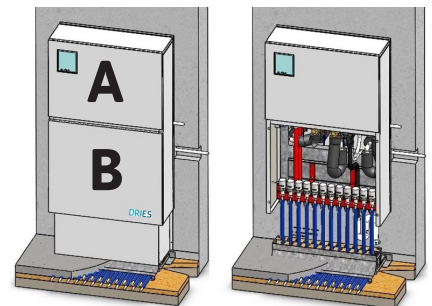
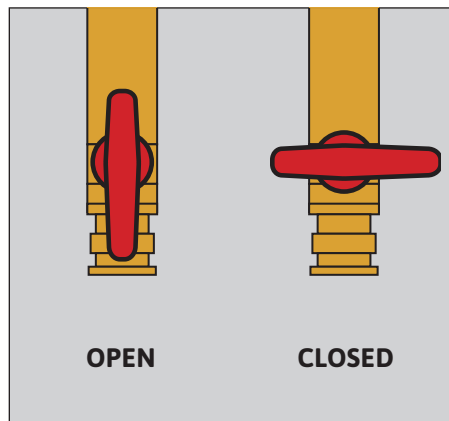
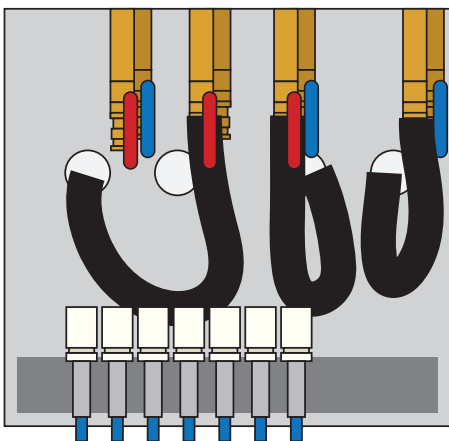

DRIES - box

A Property of Warm Cruquius

Only accessible to WarmCruquius technician.

B Property of resident

Indoor installation behind panel B.

USER MANUAL ON REVERSE SIDE

CONTACT



ONLINE

WarmCruquius.nl

- user manual

- frequently asked questions

- terms & conditions

EMAIL

info@WarmCruquius.nl



i This side: concise info about our services.

FOR YOUR CAREFREE STAY
the following actions are sufficient

Our three-step plan:

CONTACT



ONLINE

WarmCruquius.nl

- user manual
- frequently asked questions
- terms & conditions

EMAIL

info@WarmCruquius.nl

- 1** Make sure to go to our website and become a registered user. In 'My File' ('Mijn Dossier') you will find your personal details, as well as meter readings and invoices. Here you can also make any changes to your account such as contact information and address.

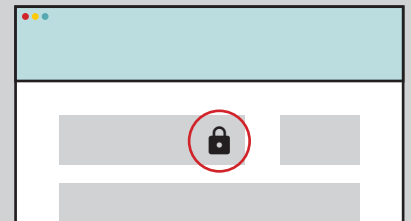

- 2** In the top left corner of the DRIES-box, you will find the energy meter with the unique serial number. Please check this number plus the meter readings, with your registration. Press the left, black control button to see the meter readings. On our website you can read more about the meter information relevant to you.

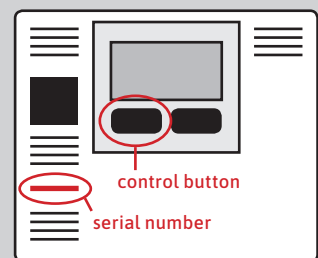

- 3** Use the control unit in your living room to easily set the desired temperature per room and enjoy the comfort. Check our website to see the available choices and tips. Find answers on the FAQ page.

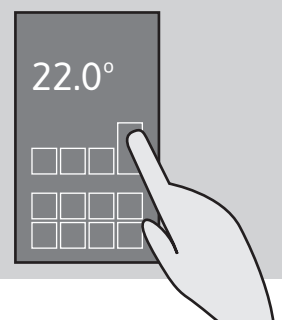

MALFUNCTION / LEAKAGE: SEE REVERSE SIDE